

Pumping Station C-Tank Volume (8000 litres) .

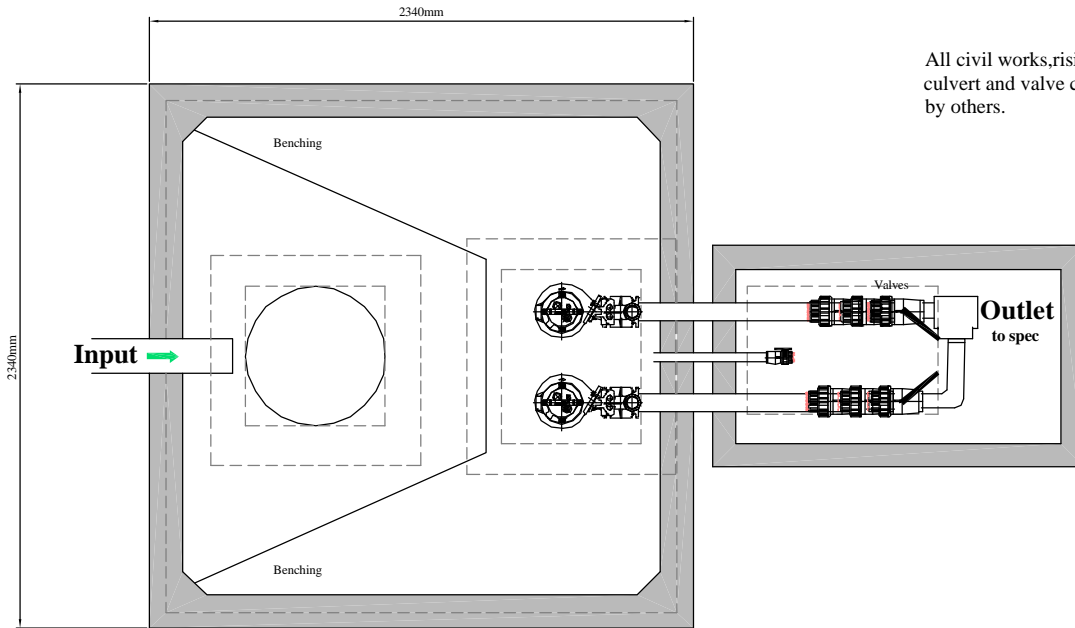

All civil works, rising main culvert and valve chamber by others.

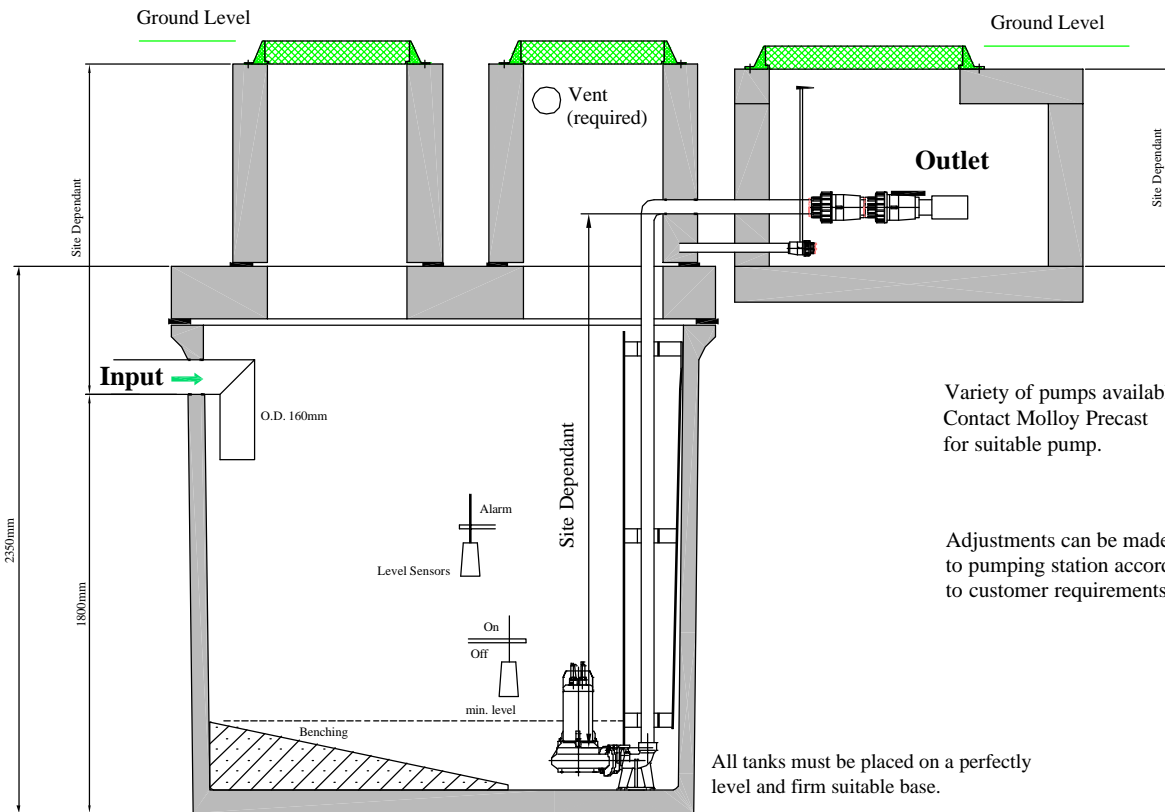

Variety of pumps available. Contact Molloy Precast for suitable pump.

Adjustments can be made to pumping station according to customer requirements.

All tanks must be placed on a perfectly level and firm suitable base.

This drawing is ©. All rights reserved.

<p>E-mail: info@molloyprecast.com Web: www.molloyprecast.com</p> 	<p>Molloy Precast Products Ltd. Coleraine, Clara Road, Tullamore, Co. Offaly. Tel: 05793 26000 Fax: 05793 26060</p>	<p>Pumping Station: C-Tank Volume (8,000 lit) Tank Size: 2340mm x 2340mm Height: 2350mm Volume: 8,000 liters Weight: 4750 Kg. (Tank Dim: ± 20mm. Weight: ± 30Kg.)</p>	<p>Note: See PDF for excavation details & safety regulations. Note: Specify hole drilling requirements. All civil works by customer. Note: Do NOT scale from drawings. Drawings for illustration purposes only.</p>
---	---	---	--