

Tank Type: C Tank

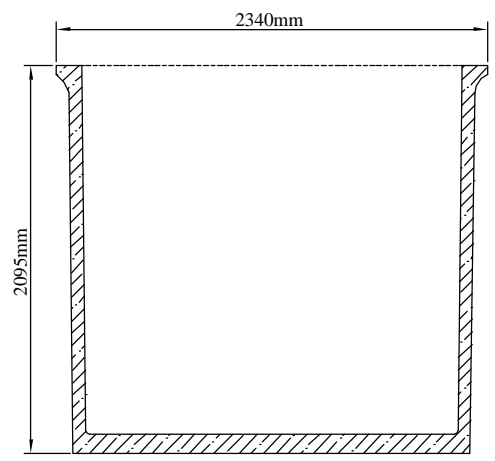

Tank Vertical Section

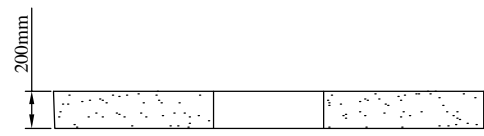
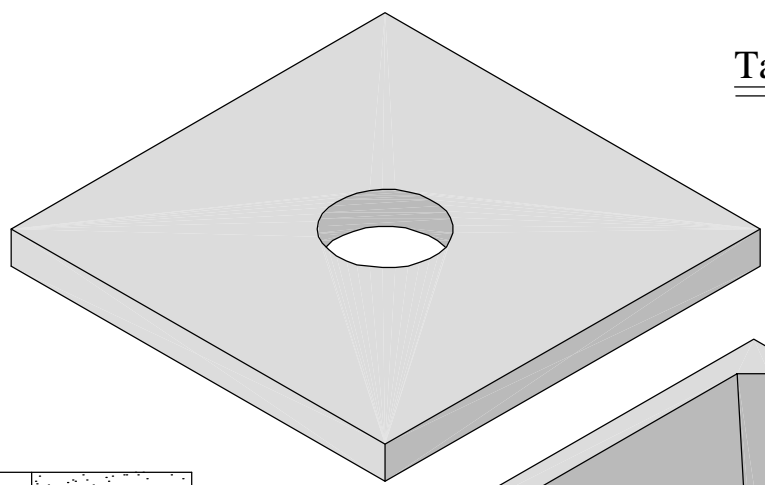

Lid Section

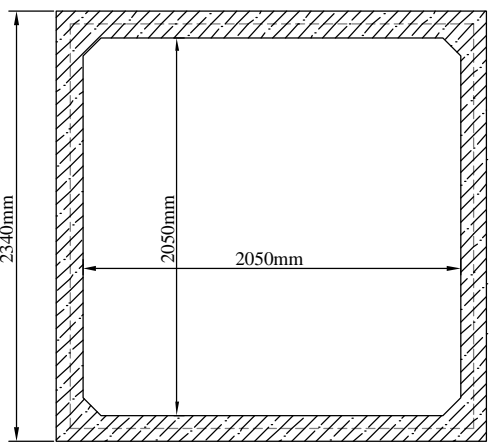

Tank Top Plan

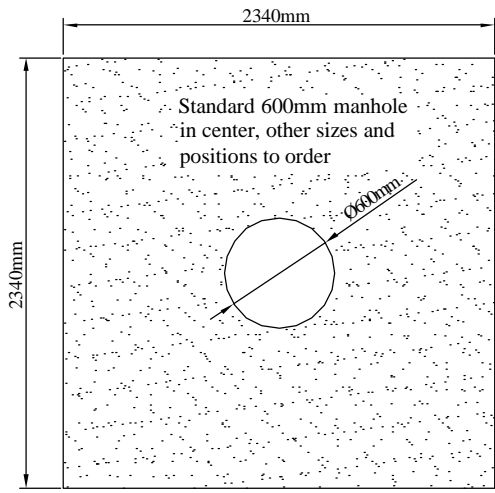

Lid Top Plan

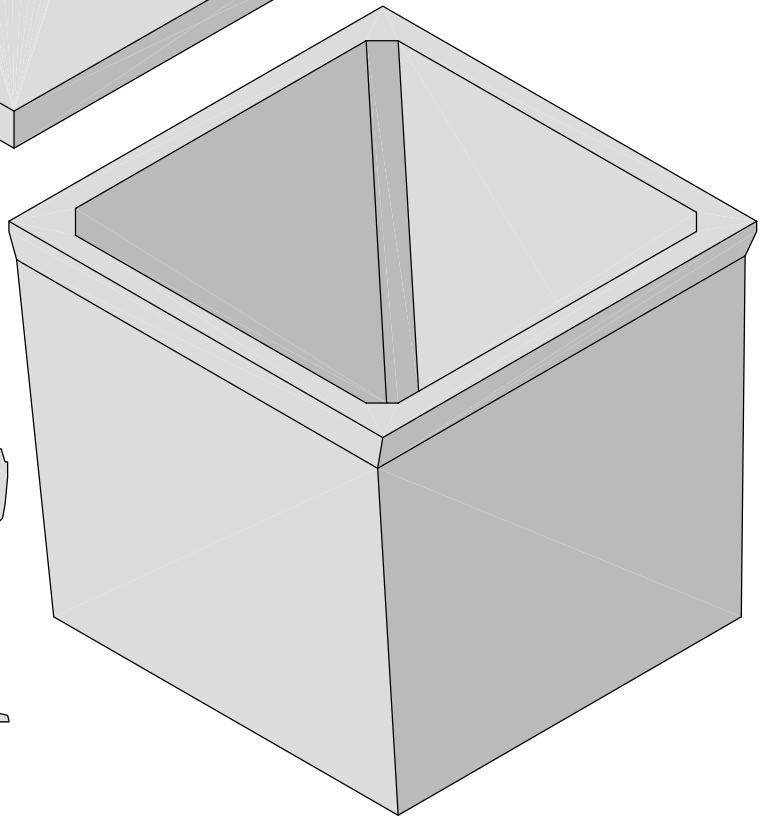
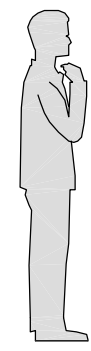

E-mail: info@molloyprecast.com
 Web: www.molloyprecast.com

Aswa from **MOLLOY PRECAST**

Molloy Precast Products Ltd.
 Coleraine, Clara Road,
 Tullamore, Co.Offaly.
 Tel: 05793 26000
 Fax: 05793 26060

Tank Type	C Tank
Tank Size	2340mm x 2340mm
Height	2095mm ex. lid & manhole
Volume	8000 liters
Weight	4750 Kg. ex.lid
(Tank Dim: ± 20mm. Weight: ± 30Kg.)	

Note: See reverse for excavation details & safety regulations.

Note: Specify hole drilling requirements. All civil works by customer.

Note: Do NOT scale from drawings. Drawings for illustration purposes only.

This drawing is ©. All rights reserved.